



ITEM NO. _____
 PROJECT _____
 LOCATION _____
 DATE _____ QTY. _____



KSUF/KSUR48

ENERGY STAR® qualification applies to undercounter refrigerator models only.

KSU SERIES

Undercounter/Worktable Refrigerators & Freezers

REFRIGERATORS

- ☐ KSUR27
- ☐ KSUR36
- ☐ KSUR48
- ☐ KSUR60
- ☐ KSUR72

FREEZERS

- ☐ KSUF27
- ☐ KSUF48
- ☐ KSUF60

FEATURES

CONSTRUCTION

- Curved corner design creates a stylish appearance and reduces chances of injury in slip-and-fall accidents
- Stainless steel interior and exterior
- Foamed-in-place with low ODP polyurethane insulation
- Wall thickness: 2"
- 6" diameter casters
- Adjustable heavy-duty vinyl-coated shelves

DOORS

- Self-closing
- Standard door swing configuration:
 - 1-door models hinged right
 - 2-door models.....left hinged left, right hinged right

- 3-door modelleft hinged left, middle door hinged left, right door hinged right

Door width:

- KSUR/KSUF27 27¹/₄"
- KSUR36 18"
- KSUR/KSUF48 23⁷/₈"
- KSUR/KSUF60 30"
- KSUR72 23⁷/₈"

REFRIGERATION

- Self-contained forced air refrigeration system
- Refrigerant:
 - KSUR models & KSUF27 R-134a
 - All other KSUF models R-404A
- Temperature range:
 - KSUR 32° to 40°F (0° to 4°C)
 - KSUF -1° to -11°F (-18° to -24°C)

WARRANTY

- **Standard limited three year parts and labor**
- **Additional two year coverage on compressor part**

OPTIONS

- ☐ Low profile casters for ADA compliance
- ☐ Single or double overshef
- ☐ Refrigerated drawers (excluding KSUR36)

BID SPECIFICATIONS

Item no. KSU _____. Provide _____ Undercounter/worktable refrigerator/freezer(s), Master-Bilt model no. KSU _____.

Undercounter will feature rounded corner construction with stainless steel interior and exterior.

The refrigeration system will be bottom

mounted and self-contained. Freezers will use R-404A refrigerant, except for KSUF27 which will use R-134a. Refrigerators will use R-134a. The temperature range will be 32° to 40°F (0° to 4° C) for refrigerators and -1° to -11°F (-18° to -24°C) for freezers.

Undercounter to have standard limited

three year parts and labor with additional two year coverage on compressor part.

Undercounter to be UL, C-UL and ETL Sanitation listed with ENERGY STAR qualification on undercounter refrigerator models.



TECHNICAL SPECIFICATIONS

MODEL	DIMENSIONS (in.)			DIMENSIONS (mm)			VOLTS	AMPS	UNIT H.P.	NO. OF DOORS	NO. OF SHELVES	CAP. CU. FT.	SHIP CU. FT.	SHIP WT. (LB/KG)	
	L	D	H*	L	D	H*									
REFRIGERATORS															
KSUR27	27 ¹ / ₂	30	35 ⁷ / ₈	699	762	911	115	3.2	1/5	1	1	7.0	21.1	199/90	
KSUR36	36 ³ / ₈	30	35 ⁷ / ₈	924	762	911	115	3.6	1/5	2	2	9.4	26.6	242/110	
KSUR48	48 ¹ / ₄	30	35 ⁷ / ₈	1226	762	911	115	7.9	3/8	2	2	13.0	35.9	280/127	
KSUR60	60 ³ / ₈	30	35 ⁷ / ₈	1534	762	911	115	7.9	3/8	2	2	16.5	44.2	333/151	
KSUR72	72 ³ / ₈	30	35 ⁷ / ₈	1838	762	911	115	8.1	3/8	3	3	20.0	52.2	384/175	
FREEZERS															
KSUF27	27 ¹ / ₂	30	35 ⁷ / ₈	699	762	911	115	8.3	3/8	1	1	7.0	21.1	207/94	
KSUF48	48 ¹ / ₄	30	35 ⁷ / ₈	1226	762	911	115	8.9	1/2	2	2	13.0	35.9	298/135	
KSUF60	60 ³ / ₈	30	35 ⁷ / ₈	1534	762	911	115	8.9	1/2	2	2	16.5	44.2	350/159	

*Height includes casters.

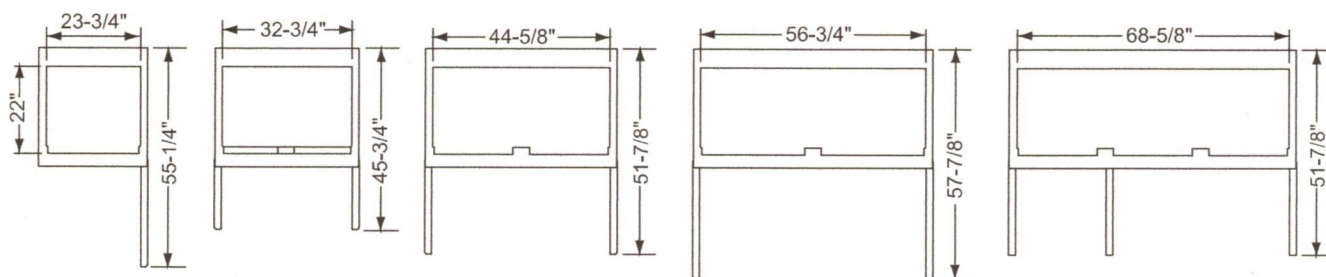

KSUR/KSUF27
PLAN VIEW

KSUR36
PLAN VIEW

KSUR/KSUF48
PLAN VIEW

KSUR/KSUF60
PLAN VIEW

KSUR72
PLAN VIEW

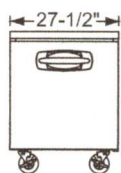

KSUR/KSUF27
ELEVATION
VIEW

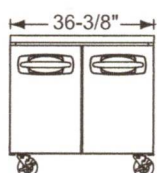

KSUR36
ELEVATION
VIEW

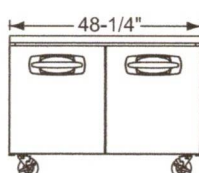

KSUR/KSUF48
ELEVATION
VIEW

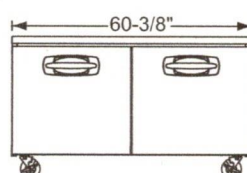

KSUR/KSUF60
ELEVATION
VIEW

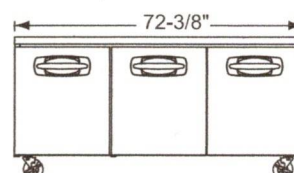

KSUR72
ELEVATION
VIEW

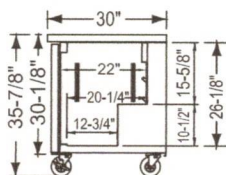

ALL MODELS
SIDE VIEW

LISTINGS



ENERGY STAR®
qualification applies
only to undercounter
refrigerator models.

HOOKUP

All models via plug in, 9 foot long flexible
three wire 14/3 cord with molded plug.



NEMA 5-15P